

CERTIFIED LAND CORNER RECORDATION

DESCRIPTION OF CORNER EVIDENCE FOUND, AND ORIGINAL RECORD (if known)

LOCATION $\frac{1}{4}$
 S.31 S.32
 T.15N., R.69W.
 6th P.M.

Found 3" x 10" x 16" granite stone with " $\frac{1}{4}$ ", lying on top of bedrock, apparently undisturbed but badly weathered.

G.L.O. record - Granite boulder, 18 x 14 x 3. Contract survey by Henry G. Hay in 1871.

DESCRIPTION OF MONUMENT AND ACCESSORIES ESTABLISHED TO PERPETUATE THE ORIGINAL LOCATION OF THIS CORNER:

At the corner: Set a 5/8" dia. x 24" long rebar with Surv KAP in crack in granite bedrock.

Accessories: R.P. No. 1 - A chiseled "X" and "NO 1" in granite outcrop bears S 52°48' W, 34.11 feet distant.

R.P. No. 2 - A chiseled "X" and "NO 2" in granite outcrop bears N 56°47'30" W, 49.37 feet distant.

SKETCH, WITH COURSE AND DISTANCE TO ADJACENT CORNER IF DETERMINED IN THIS SURVEY.
 (May Sketch or Paste Reproduction on Reverse Side.)

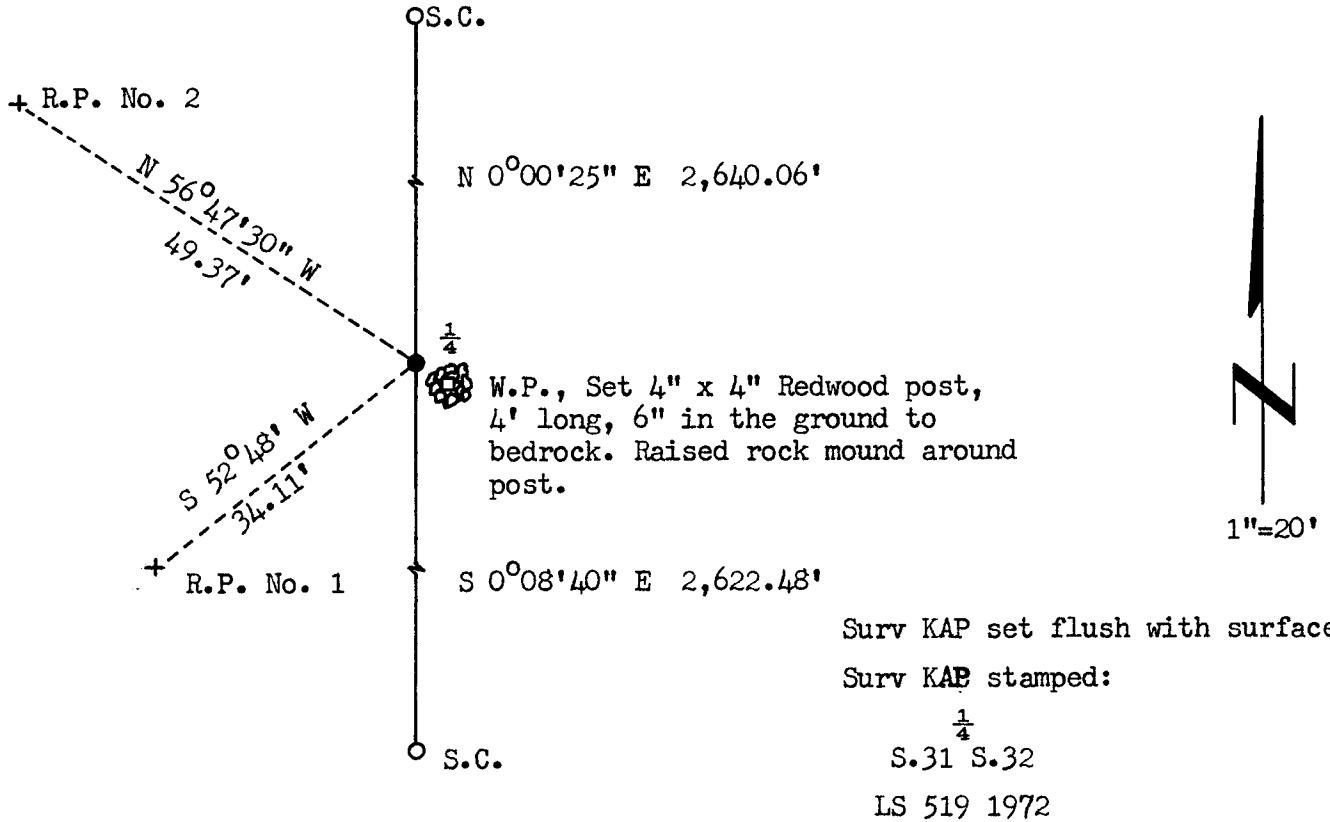

I, R.L. Hudson certify that I have carefully performed ~~or reviewed~~ the work done on the diagrammed corner as reported on this recordation form and approve the same.

R.L. Hudson Wyoming L.S. No. 519
 Signature of Surveyor Registration No.

STATE OF WYOMING,
 Office of Clerk and Recorder,
 County of Laramie

This "corner record" was filed for record on the 30th day of October, 1972, was noted on the cross-index plat and is assigned page No. 15-69, in book No. ONA

John B. Hollister
 County Official

Cross Index No. _____	T. _____	R. _____	Mer. _____
_____	T. _____	R. _____	Mer. _____
_____	T. _____	R. _____	Mer. _____
_____	T. _____	R. _____	Mer. _____
_____	T. _____	R. _____	Mer. _____
_____	T. _____	R. _____	Mer. _____
_____	T. _____	R. _____	Mer. _____

The State of Wyoming }
County of Laramie } SS

This instrument was filed for record
at 2:43 o'clock P.M. on the
21th day of October
A. D. 1922 and duly recorded in
Book



County Clerk & Ex-Officio Register of Deeds
....., Deputy